

ELENCO PARTI / PARTS LIST

| # | QTÀ / QTY | DESCRIZIONE / DESCRIPTION | CODICE / CODE |
|----|-----------|---|---------------|
| 1 | 1 | DB killer / DB killer | 50.DK.092.0 |
| 2 | 1 | Silenziatore / Muffler | OVAL STEEL |
| 3 | 1 | Staffa / Bracket | 50.SS.030.0 |
| 4 | 1 | Protezione per staffa / Bracket protection | 50.73.077.1 |
| 5 | 1 | Vite M8x100 / Screw M8x100 | 50.73.173.1 |
| 6 | 1 | Rondella in alluminio / Aluminium washer (Ø35mm) | 50.73.063.1 |
| 7 | 1 | Distanziale in alluminio / Aluminium spacer | 50.SS.741.1 |
| 8 | 6 | Dado M8 flangiato / Flanged nut M8 | 50.73.393.1 |
| 9 | 1 | Staffa / Bracket | 50.SS.844.0 |
| 10 | 1 | Vite M6x20 / Screw M6x20 | 50.73.420.1 |
| 11 | 2 | Rondella M6 / Washer M6 | 50.73.187.1 |
| 12 | 1 | Dado M6 autobloccante / M6 locknut | 50.73.112.1 |
| 13 | 1 | Vite M8x25 / Screw M8x25 | 50.73.064.1 |
| 14 | 1 | Rondella alluminio / Aluminium washer (Ø30mm) | 50.73.291.1 |
| 15 | 1 | Db Killer forato / Drilled DB killer | 50.DK.082.0 |
| 16 | 1 | Tubo di raccordo / Link pipe | 9773Y044S2 |
| 17 | 1 | Tubo di raccordo 2-1 / Link pipe 2-1 | 9773Y044C1C |
| 18 | 1 | Collettore #2 / Down pipe #2 | 9773Y044C1B |
| 19 | 1 | Collettore #1 / Down pipe #1 | 9773Y044C1A |
| 20 | 4 | Molla media / Middle spring | 50.73.359.1 |
| 21 | 4 | Gommino per molla / Rubber for spring | 50.73.049.0 |
| 22 | 1 | Tappo per sonda lambda / Stopper for lambda probe | 50.73.111.1 |

- Rimuovere il supporto del terminale originale / Remove the support of the original exhaust
- Parte di telaio su cui fissare la staffetta STORM / Frame part where STORM's bracket shall be fixed
- Fissaggio staffetta STORM / STORM's bracket fixing
- Fissaggio terminale STORM / STORM's exhaust fixing

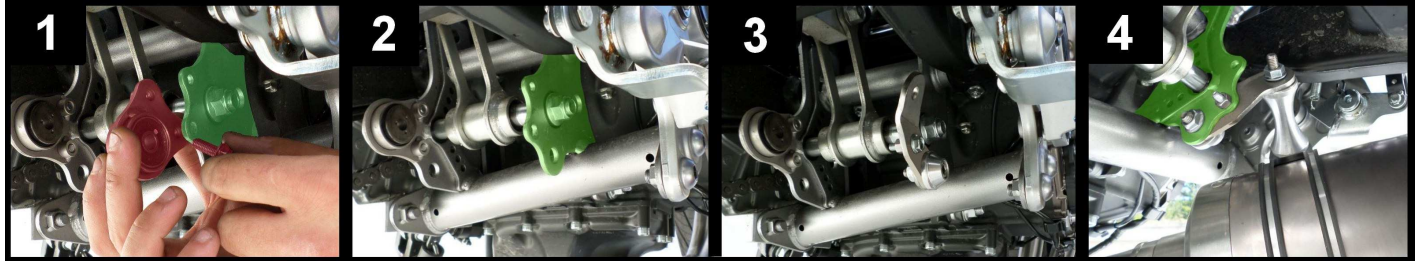

APPLICAZIONI / APPLICATIONS

| CODICE / CODE | TUBO / PIPE | SILENZIATORE / MUFFLER | FASCETTA / CLAMP | NOTE |
|---------------|-----------------|------------------------|------------------|----------------------------------|
| 74.Y.053.LX1 | INOX / ST.STEEL | INOX / ST.STEEL | INOX / ST.STEEL | CATALYTIC CONVERTER NOT INCLUDED |
| 74.Y.053.KX1 | INOX / ST.STEEL | INOX / ST.STEEL | INOX / ST.STEEL | CATALYTIC CONVERTER INCLUDED |